

Needle Roller Bearings

Both metric type and inch type needle roller bearings have various design types, common types include: needle roller bearings with solid rings, drawn cup needle roller bearings, radial needles & cage assemblies, thrust needle roller bearings, thrust needle rollers & cage assemblies, etc.

Needle roller bearings can support large pure radial load only, can't be used to locate the bearing and bearing housing.

Needle roller bearings are especially suitable for applications with limited radial installation space. Needle roller bearings are widely used in automobile, motorcycle, electric tool, textile, agricultural machinery, printing machinery, construction machinery, automatic instrument etc.



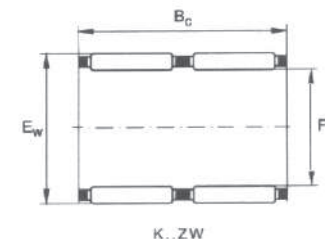
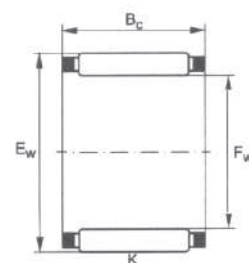
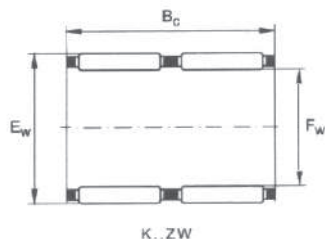
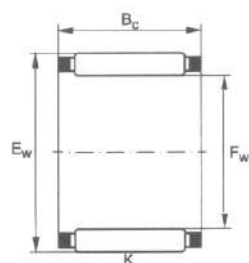

Shaft Diameter (mm)	Bearing Designations	Weight (g)	Principal Dimensions (mm)			Basic Load Ratings (KN)		Limiting Speed (rpm) Oil lubrication			Shaft Diameter (mm)	Bearing Designations	Weight (g)	Principal Dimensions (mm)			Basic Load Ratings (KN)		Limiting Speed (rpm) Oil lubrication
			Fw	Ew	Bc	Dynamic Cr	Static Cor							Fw	Ew	Bc	Dynamic Cr	Static Cor	
3	K3×5×7 TN	0.3	3	5	7	1.54	1.29	50000			14	K14×18×10	4	14	18	10	7.1	8.5	25000
	K3×5×9 TN	0.4	3	5	9	1.71	1.48	50000				K14×18×13	6.3	14	18	13	8.2	10.1	25000
	K3×6×7 TN	0.4	3	6	7	1.43	0.97	47000				K14×18×15	7.3	14	18	15	9.5	12.3	25000
4	K4×7×7 TN	0.5	4	7	7	2.33	1.84	43000			14	K14×18×17	8.1	14	18	17	10.8	14.4	25000
	K4×7×10 TN	0.7	4	7	10	2.35	1.92	43000				K14×20×12	8.2	14	20	12	10.3	10.6	25000
5	K5×8×8 TN	0.7	5	8	8	2.3	1.88	39000			15	K15×18×17	6.4	15	18	17	8	12.1	24000
	K5×8×10 TN	0.9	5	8	10	2.8	2.45	39000				K15×19×10	5.1	15	19	10	7.5	9.2	25000
6	K6×9×8 TN	0.8	6	9	8	2.56	2.24	37000			15	K15×19×13	7	15	19	13	8.5	10.9	24000
	K6×9×10 TN	1	6	9	10	3.3	3.1	37000				K15×19×17	8.8	15	19	17	11.3	15.6	24000
	K6×10×13 TN	1.3	6	10	13	3.5	2.8	35000				K15×20×13	7	15	20	13	9.9	11.5	24000
7	K7×9×7 TN	0.6	7	9	7	1.73	1.77	35000			15	K15×21×15	13	15	21	15	14.3	16.4	24000
	K7×10×8 TN	0.9	7	10	8	2.75	2.55	34000				K15×21×21	18.2	15	21	21	19.4	24.3	24000
	K7×10×10 TN	1.1	7	10	10	3.35	3.4	34000				K16×20×10	5.7	16	20	10	7.8	9.9	24000
8	K8×11×8 TN	1.1	8	11	8	3	2.9	32000			16	K16×20×13	7.7	16	20	13	8.9	11.8	24000
	K8×11×10 TN	1.7	8	11	10	3.83	3.95	32000				K16×20×17	9.2	16	20	17	11.7	16.8	24000
	K8×11×13 TN	1.8	8	11	13	5	5.7	32000				K16×22×12	10.4	16	22	12	11.5	12.5	23000
	K8×12×10 TN	2.3	8	12	10	4.9	4.6	32000				K16×22×16	13.7	16	22	16	14.8	17.5	23000
9	K9×12×10 TN	1.5	9	12	10	4.2	4.7	31000			16	K16×22×20	16.7	16	22	20	18.3	22.8	23000
	K9×12×13 TN	1.9	9	12	13	5.5	6.7	31000				K16×24×20	24.9	16	24	20	21.4	23.5	22000
10	K10×13×10 TN	1.6	10	13	10	4.5	5.25	29000			17	K17×21×10	5.5	17	21	10	8.1	10.6	23000
	K10×13×13 TN	2.1	10	13	13	6	7.6	29000				K17×21×13	6.5	17	21	13	10.4	14.6	23000
	K10×13×16 TN	2.2	10	13	16	6.5	7.8	29000				K17×21×17	9.5	17	21	17	12.2	17.9	23000
	K10×14×10 TN	2.9	10	14	10	7.0	7.9	29000				K18×22×10	6	18	22	10	8.4	11.3	22000
	K10×14×13 TN	4.3	10	14	13	8	9.1	29000				K18×22×13	8	18	22	13	9.2	12.7	22000
	K10×16×12 TN	3.7	10	16	12	7	9.3	28000				K18×22×17	11	18	22	17	12.1	18	22000
12	K12×15×10 TN	1.9	12	15	10	4.32	5.73	27000			18	K18×24×12	12	18	24	12	12.8	14.9	22000
	K12×15×13 TN	2.4	12	15	13	6	8.1	27000				K18×24×13	13	18	24	13	13.1	15.3	22000
	K12×16×13 TN	3.8	12	16	13	7.9	9.2	27000				K18×24×20	18	18	24	20	20.2	27	22000
	K12×17×13 TN	4.4	12	17	13	9.3	10	26000				K18×25×22	23	18	25	22	23.1	29	22000
	K12×18×12 TN	5	12	18	12	9.8	8	26000				K19×23×13	8	19	23	13	9.5	13.5	22000
											19	K19×23×17	11	19	23	17	12.5	19.2	22000

TN is nylon cage, the running temperature is less than 120°C

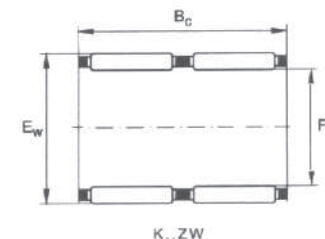
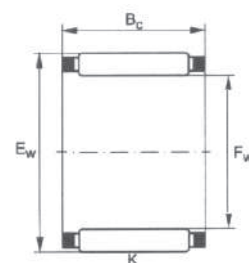
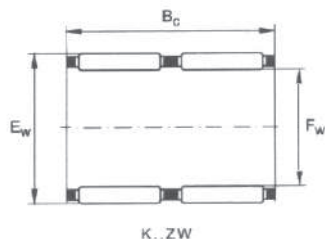
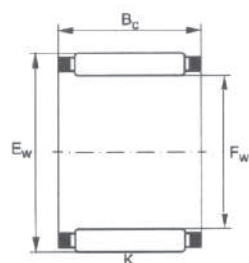

Shaft Diameter (mm)	Bearing Designations	Weight (g)	Principal Dimensions (mm)			Basic Load Ratings (KN)		Limiting Speed (rpm) Oil lubrication			Shaft Diameter (mm)	Bearing Designations	Weight (g)	Principal Dimensions (mm)			Basic Load Ratings (KN)		Limiting Speed (rpm) Oil lubrication
			Fw	Ew	Bc	Dynamic Cr	Static Cor							Fw	Ew	Bc	Dynamic Cr	Static Cor	
20	K20×24×10	6.5	20	24	10	8.9	12.6	21000		25	K25×29×10	8.5	25	29	10	9.9	15.4	18000	
	K20×24×13	9	20	24	13	9.8	14.3	21000			K25×29×13	11	25	29	13	11.3	18.4	18000	
	K20×24×17	12	20	24	17	12.9	20.4	21000			K25×29×17	14	25	29	17	14.9	26	18000	
	K20×26×12	11	20	26	12	31.4	16.2	21000			K25×30×17	16	25	30	17	18.7	30	18000	
	K20×26×13	12	20	26	13	14.4	17.9	21000			K25×30×20	18	25	30	20	21.7	36.5	18000	
	K20×26×17	16	20	26	17	19.2	26	21000			K25×30×26 ZW	19	25	30	26	21.4	35.5	18000	
	K20×26×20	19	20	26	20	21.1	29	21000			K25×31×17	19	25	31	17	19.6	28.5	18000	
	K20×28×16	20	20	28	16	19.8	22.4	20000			K25×31×21	20	25	31	21	24.7	38	18000	
	K20×28×20	27	20	28	20	23.9	28.5	20000			K25×32×16	21	25	32	16	20.8	27.5	17000	
	K20×28×25	32	20	28	25	30.5	39	20000			K25×33×20	33	25	33	20	28.5	38	17000	
K20×30×30	49	20	30	30	35.5	41.5	20000		K25×33×24	39	25	33	24	34	47	17000			
21	K21×25×13	9	21	25	13	10.1	15.1	21000		K25×35×30	65	25	35	30	47	62	16000		
22	K22×26×10	7.5	22	26	10	9.1	13.4	20000		26	K26×30×13	11	26	30	13	11.6	19.2	18000	
	K22×26×13	9.5	22	26	13	10.4	15.9	20000			K26×30×17	15	26	30	17	15.2	27.5	18000	
	K22×26×17	12	22	26	17	13.7	22.7	20000			K26×30×22 ZW	12	26	30	22	15.7	28.5	18000	
	K22×28×17	18	22	28	17	19.4	27	20000		28	K28×33×13	13	28	33	13	15.3	24.2	16000	
	K22×29×16	16	22	29	16	20	25.5	19000			K28×33×17	17	28	33	17	19.7	33.5	16000	
	K22×30×15 TN	18	22	30	15	20.1	23.4	19000			K28×34×17	24	28	34	17	21.8	33.5	16000	
K22×32×24	43	22	32	24	34	40	18000		K28×35×16		24	28	35	16	21.5	29.5	16000		
23	K23×35×16 TN	29	23	35	16	24.5	23.9	17000		K28×35×18	27	28	35	18	24	34	16000		
24	K24×28×10	8.5	24	28	10	9.6	14.8	19000		K28×40×25	70	28	40	25	45.5	55	14000		
	K24×28×13	10	24	28	13	11	17.6	19000		30	K30×34×13	14	30	34	13	12.3	21.7	15000	
	K24×28×17	13	24	28	17	14.5	25	19000			K30×35×13	14	30	35	13	15.6	25.5	15000	
	K24×30×17	19	24	30	17	19.5	27.5	18000			K30×35×17	19	30	35	17	19.6	34	15000	
	K24×30×31 ZW	32	24	30	31	27.5	43.5	18000			K30×35×27	30	30	35	27	30.5	59	15000	
									K30×37×16		27	30	37	16	23.1	33.5	15000		
									K30×37×18	30	30	37	18	26	38.5	15000			
									K30×40×18	48	30	40	18	32	40	14000			
									K30×40×30	73	30	40	30	49	69	15000			

TN is nylon cage, the running temperature is less than 120°C

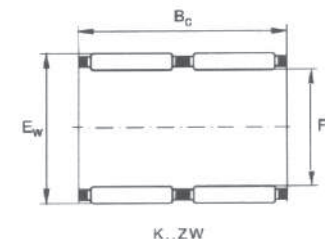
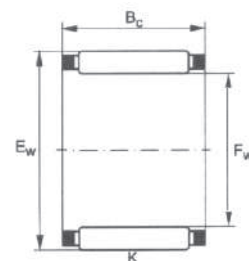
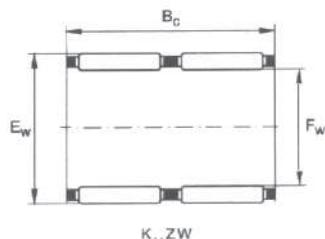
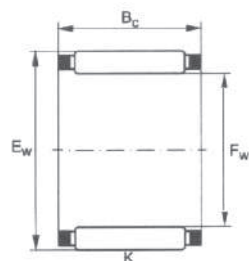

Shaft Diameter (mm)	Bearing Designations	Weight (g)	Principal Dimensions (mm)			Basic Load Ratings (KN)		Limiting Speed (rpm) Oil lubrication			Shaft Diameter (mm)	Bearing Designations	Weight (g)	Principal Dimensions (mm)			Basic Load Ratings (KN)		Limiting Speed (rpm) Oil lubrication
			Fw	Ew	Bc	Dynamic Cr	Static Cor							Fw	Ew	Bc	Dynamic Cr	Static Cor	
32	K32×37×13	18	32	37	13	15.5	25.5	14000		40	K40×45×13	22	40	45	13	17.6	32.5	12000	
	K32×37×17	19	32	37	17	19.9	35.5	14000			K40×45×17	31	40	45	17	21.4	41.5	12000	
	K32×37×27	30	32	37	27	30	60	14000			K40×45×27	46	40	45	27	33	73	12000	
	K32×38×20	30	32	38	20	26.5	45	14000			K40×47×18	39	40	47	18	29.5	50	11000	
	K32×39×16	37	32	39	16	23.8	35.5	14000			K40×47×20	42	40	47	20	32.5	57	11000	
	K32×39×18	31	32	39	18	26.5	41	14000			K40×48×20	49	40	48	20	36	59	11000	
	K32×40×25	49	32	40	25	37.5	58	14000			K42×47×13	18	42	47	13	17.8	33.5	11000	
	K32×40×42 ZW TN	77	32	40	42	50	84	14000			K42×47×17	32	42	47	17	21.7	43	11000	
35	K32×46×32	119	32	46	32	66	84	13000		K42×47×30 ZW	54	42	47	30	33.5	76	11000		
	K35×40×13	19	35	40	13	16.2	28	13000		K42×50×20	53	42	50	20	35	57	11000		
	K35×40×17	21	35	40	17	20.8	38.5	13000		43	K43×48×17	30	43	48	17	21.6	43	11000	
	K35×40×25	31	35	40	25	29.5	60	13000			K43×48×27	50	43	48	27	33.5	75	11000	
	K35×40×27 TN	39	35	40	27	25	48.5	13000		45	K45×50×17	34	45	50	17	22.5	46	10000	
	K35×42×16	34	35	42	16	24.4	37.5	13000			K45×50×27	51	45	50	27	34.5	80	10000	
	K35×42×18	34	35	42	18	27.5	43	13000			K45×52×18	42	45	52	18	31.5	57	10000	
	K35×42×20	37	35	42	20	30	49	13000			K45×53×20	55	45	53	20	39	67	10000	
K35×42×30	67	35	42	30	39	68	13000		K45×53×21		60	45	53	21	38.5	67	10000		
K35×45×20	56	35	45	20	37	50	12000		K45×53×28		81	45	53	28	52	98	10000		
K35×45×30	80	35	45	30	53	79	12000		K45×59×18 TN		72	45	59	18	44	54	9500		
37	K37×42×17	22	37	42	17	22.4	43	12000		K45×59×32	148	45	59	32	73	103	9500		
	38	K38×43×17	29	38	43	17	20.5	38.5	12000		47	K47×52×17	35	47	52	17	23.5	49	10000
		K38×43×27	43	38	43	27	31.5	68	12000			K47×52×27	51	47	52	27	35	83	10000
		K38×46×20	47	38	46	20	35.5	57	12000										
K38×46×32	76	38	46	32	55	99	12000												
39	K39×44×26 ZW	45	39	44	26	27.5	56	12000											

TN is nylon cage, the running temperature is less than 120°C

TN is nylon cage, the running temperature is less than 120°C

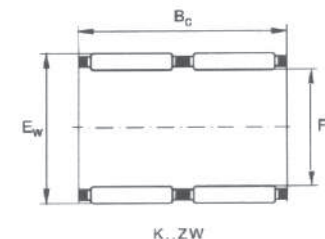
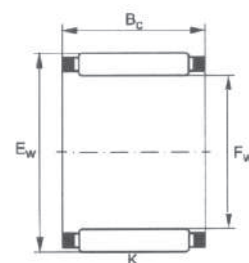
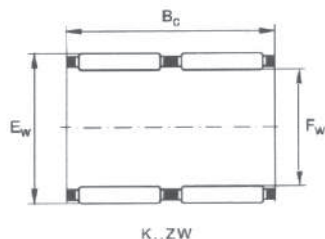
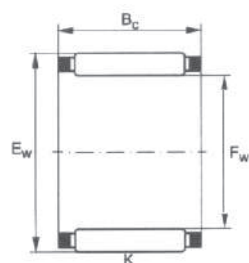

Shaft Diameter (mm)	Bearing Designations	Weight (g)	Principal Dimensions (mm)			Basic Load Ratings (KN)		Limiting Speed (rpm) Oil lubrication			Shaft Diameter (mm)	Bearing Designations	Weight (g)	Principal Dimensions (mm)			Basic Load Ratings (KN)		Limiting Speed (rpm) Oil lubrication
			Fw	Ew	Bc	Dynamic Cr	Static Cor							Fw	Ew	Bc	Dynamic Cr	Static Cor	
50	K50×55×13.5	30	50	55	13.5	18.2	36.5	9500		65	K65×70×20	56	65	70	20	30.5	77	7500	
	K50×55×17	35	50	55	17	22.1	47	9500	K65×70×30		83	65	70	30	44	127.4	7500		
	K50×55×20	43	50	55	20	26.5	60	9500	K65×73×23		108	65	73	23	46	94	7000		
	K50×55×30	65	50	55	30	39	97	9500	K65×73×30		141	65	73	30	57	123	7000		
	K50×57×18	47	50	57	18	33.5	63	9000	K68×74×20		71	68	74	20	35.5	84	7000		
	K50×58×20	75	50	58	20	35.5	62	9000	K68×74×30		100	68	74	30	46.5	118	7000		
	K50×58×25	90	50	58	25	44	81	9000	K68×74×35 ZW		120	68	74	35	48.5	125	7000		
52	K52×57×12	24	52	57	12	18	36.5	9000		70	K70×76×20	71	70	76	20	36	86	6500	
55	K55×60×20	40	55	60	20	28.5	66	8500	K70×76×30		110	70	76	30	52	139	6500		
	K55×60×27	60	55	60	27	38	97	8500	K70×78×30		120	70	78	30	60	135	6500		
	K55×60×30	71	55	60	30	41	108	8500		72	K72×80×20	98	72	80	20	41.5	85	6500	
	K55×62×18	52	55	62	18	35.5	70	8500		73	K73×79×20	75	73	79	20	37	90	6500	
	K55×63×20	67	55	63	20	40	74	8500		75	K75×81×20	79	75	81	20	37.5	94	6500	
	K55×63×25	80	55	63	25	51	101	8500	K75×81×30		114	75	81	30	52	143	6500		
K55×63×32	102	55	63	32	62	130	8500	K75×83×23	124		75	83	23	50	109	6000			
58	K58×65×18	52	58	65	18	35	70	8000	K75×83×30		147	75	83	30	62	143	6000		
	K58×65×36 ZW	127	58	65	36	49	107	8000	K75×83×35 ZW	182	75	83	35	63	147	6000			
60	K60×65×20	52	60	65	20	29.5	72	8000	K75×83×40 ZW	211	75	83	40	73	177	6000			
	K60×65×30	77	60	65	30	42.5	116	8000		80	K80×86×20	60	80	86	20	38.5	98	6000	
	K60×66×33 ZW	104	60	66	33	46	112	8000	K80×88×30		138	80	88	30	71	176	6000		
	K60×66×40 ZW	116	60	66	40	58	151	8000	K80×88×40 ZW		227	80	88	40	76	192	6000		
	K60×68×20	71	60	68	20	43.5	85	7500	K80×88×46 ZW		260	80	88	46	88	231	6000		
	K60×68×23	94	60	68	23	49.5	101	7500		85	K85×92×20	102	85	92	20	44.5	108	5500	
	K60×68×25	89	60	68	25	53	111	7500		90	K90×97×20	109	90	97	20	45	113	5000	
	K60×68×30 ZW	129	60	68	30	44.5	88	7500	K90×98×27		150	90	98	27	61	150	5000		
K60×75×42	240	60	75	42	118	199	7500	K90×98×30	172		90	98	30	68	172	5000			
62	K62×70×40 ZW	174	62	70	40	66	146	7500		95	K95×103×30	165	95	103	30	69	180	4900	
64	K64×70×16	53	64	70	16	28	60	7500	K95×103×40 ZW		266	95	103	40	83	228	4900		

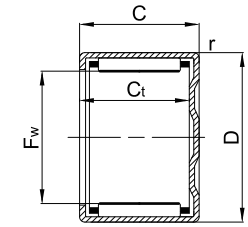
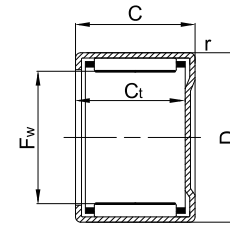
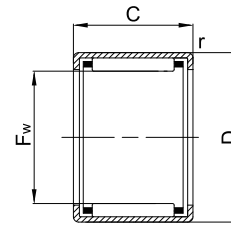
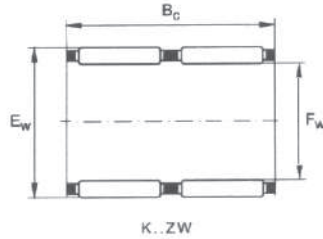
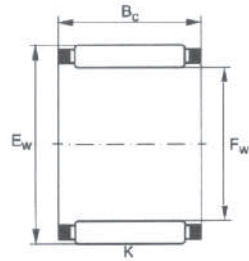

HK

BK(3mm < Fw < 25mm)

BK(Fw ≥ 25mm)

Shaft Diameter (mm)	Bearing Designations	Weight (g)	Principal Dimensions (mm)			Basic Load Ratings (KN)		Limiting Speed (rpm) Oil lubrication	Shaft Diameter (mm)	Principal Dimensions (mm)					Open End		Close End		Basic Load Ratings (KN)		Limiting Speed (rpm) Oil lubrication
			Fw	Ew	Bc	Dynamic Cr	Static Cor			Fw	D	C	Ct min	r min	Bearing Designations	Weight (g)	Bearing Designations	Weight (g)	Dynamic Cr	Static Cor	
100	K100×107×21	120	100	107	21	48	127	4700	3	3	6.5	6	5.2	0.3	+HK 0306 TN	1	+BK 0306 TN	1	1.23	0.84	46000
	K100×108×27	185	100	108	27	57	143	4700	4	4	8	8	6.4	0.3	+HK 0408	2	+BK 0408	2	1.78	1.31	41000
	K100×108×30	180	100	108	30	71	188	4700	5	5	9	9	7.4	0.4	+HK 0509	2	+BK 0509	2	2.1	1.99	38000
105	K105×112×21	129	105	112	21	47.5	127	4500	6	6	10	8	-	0.4	+HK 0608	2.1	-	-	2.03	1.65	35000
	K110×117×24	172	110	117	24	56	158	4300	6	6	10	9	7.4	0.4	HK 0609	2.5	BK 0609	2.6	2.85	2.6	35000
110	K110×118×30	217	110	118	30	78	219	4300	7	7	11	9	7.4	0.4	HK 0709	2.6	BK 0709	2.9	3.1	2.95	31000
115	K115×123×27	200	115	123	27	63	170	4100	8	8	12	8	6.4	0.4	HK 0808	2.7	BK 0808	3	2.75	2.6	28000
120	K120×127×24	165	120	127	24	59	174	4000	8	8	12	10	8.4	0.4	HK 0810	3	BK 0810	3.4	3.8	3.95	28000
125	K125×133×35	275	125	133	35	86	260	3800	9	9	13	8	-	0.4	HK 0908	3	-	-	3.55	3.75	25000
130	K130×137×24	170	130	137	24	61	186	3700	9	9	13	10	8.4	0.4	HK 0910	4	BK 0910	4.3	4.25	4.65	25000
135	K135×143×35	300	135	143	35	91	290	3500	9	9	13	12	10.4	0.4	HK 0912	4.6	BK 0912	4.9	5.3	6.3	25000
145	K145×153×26	262	145	153	26	74	225	3300	10	10	14	10	8.4	0.4	HK 1010	4.1	BK 1010	4.3	4.4	5.1	23000
150	K150×160×46	570	150	160	46	147	470	3200	10	10	14	12	10.4	0.4	HK 1012	4.8	BK 1012	5	5.5	6.8	23000
155	K155×163×26	265	155	163	26	75	236	3100	10	10	14	15	13.4	0.4	HK 1015	6	BK 1015	6.2	6.8	8.8	23000
160	K160×170×46	550	160	170	46	152	510	3000	12	12	16	10	8.4	0.4	HK 1210	4.6	BK 1210	5.2	4.95	6.2	20000
165	K165×173×26	320	165	173	26	81	265	2900	12	12	18	12	9.3	0.8	HK 1212	9	BK 1212	10	6.5	7.3	19000
175	K175×183×32	400	175	183	32	99	350	2700	13	13	19	12	9.3	0.8	HK 1312	10	BK 1312	11	6.8	7.9	18000
185	K185×195×37	607	185	195	37	128	245	2600	14	14	20	12	9.3	0.8	HK 1412	10.5	BK 1412	12	7.1	8.5	16000
195	K195×205×37	620	195	205	37	133	450	2500	15	15	21	12	9.3	0.8	HK 1512	11	BK 1512	13	7.9	9.4	16000
210	K210×220×42	740	210	220	42	154	560	2300	15	15	21	16	13.3	0.8	HK 1516	15	BK 1516	17	10.5	14.4	16000
220	K220×230×42	790	220	230	42	158	590	2200	15	15	21	22	-	0.8	HK 1522	20	-	-	13.4	19.5	16000
240	K240×250×42	850	240	250	42	164	630	2000	16	16	22	12	9.3	0.8	HK 1612	12	BK 1612	14	7.6	9.7	15000
265	K265×280×50	1810	265	280	50	255	860	1800	16	16	22	16	13.3	0.8	HK 1616	16	BK 1616	18	10.9	15.3	15000
									16	16	22	22	19.3	0.8	*HK 1622	22	*BK 1622	24	13.1	19.4	15000
									17	17	23	12	-	0.8	HK 1712	12	-	-	7.9	10.3	14000
									18	18	24	12	9.3	0.8	HK 1812	13	BK 1812	15	8.1	10.9	13000
									18	18	24	16	13.3	0.8	HK 1816	18	BK 1816	20	11.6	17.3	13000
									20	20	26	10	-	0.8	HK 2010	12	-	-	6.4	8.2	12000
									20	20	26	12	-	0.8	HK 2012	14	-	-	8.6	12.1	12000
									20	20	26	16	13.3	0.8	HK 2016	19	BK 2016	22	12.7	20.1	12000
									20	20	26	20	17.3	0.8	HK 2020	24	BK 2020	27	15.7	26	12000
									20	20	26	30	-	0.8	*HK 2030	35	-	-	21.8	40	12000
									22	22	28	10	-	0.8	HK 2210	13	-	-	7.5	10.5	11000
									22	22	28	12	9.3	0.8	HK 2212	15	BK 2212	18	9.1	13.4	11000
									22	22	28	16	13.3	0.8	HK 2216	21	BK 2216	24	13.4	22.1	11000
									22	22	28	20	-	0.8	HK 2220	26	-	-	16.5	29	11000

TN is nylon cage, the running temperature is less than 120°C
 Part no. marked with symbol +, means such bearings are without lubrication holes.
 Part no. marked with symbol °, means such bearings are of standard double-row needle roller bearings, with lubrication holes.

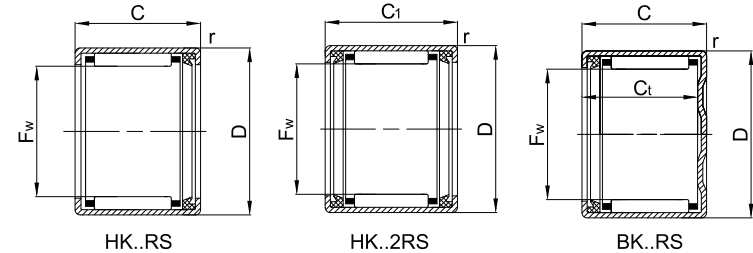
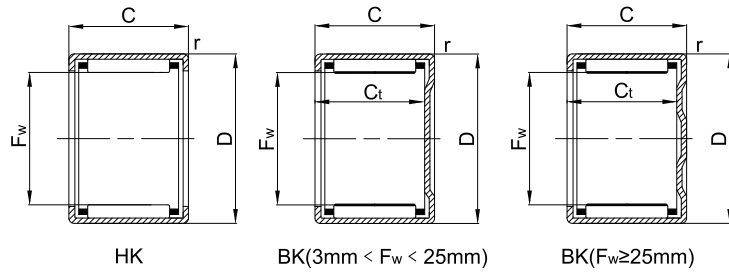

Shaft Diameter (mm)	Principal Dimensions (mm)					Open End		Close End		Basic Load Ratings (KN)		Limiting Speed (rpm) Oil Lubrication		Shaft Diameter (mm)	Principal Dimensions (mm)					Open End		Close End		Basic Load Ratings (KN)		Limiting Speed (rpm) Oil Lubrication			
	Fw	D	C	Ct min	r min	Bearing Designations	Weight (g)	Bearing Designations	Weight (g)	Dynamic Cr	Static Cor				Fw	D	C	C1	Ct min	r min	One Side Sealed Designations	Weight (g)	Double Sides Sealed Designations	Weight (g)	Bearing Designations		Weight (g)	Dynamic Cr	Static Cor
25	25	32	12	-	0.8	HK 2512	20	-	-	11	15.2	10000		8	8	12	10	12	-	0.4	HK 0810 RS	3	HK 0812.2 RS	3.3	-	-	2.75	2.6	20000
	25	32	16	13.3	0.8	HK 2516	27	BK 2516	32	15.5	24	10000		10	10	14	12	14	-	0.4	HK 1012 RS	4.2	HK 1014.2 RS	4.6	-	-	4.4	5.1	17000
	25	32	20	17.3	0.8	HK 2520	33	BK 2520	38	19.9	33	10000		12	12	18	14	16	-	0.8	HK 1214 RS	10	HK 1216.2 RS	11	-	-	6.5	7.3	14000
	25	32	26	23.3	0.8	HK 2526	44	BK 2526	48	25.5	45	10000		14	14	20	14	16	11.3	0.8	HK 1414 RS	12	HK 1416.2 RS	13	BK 1414 RS	13	7.1	8.5	12000
	25	32	38	35.3	0.8	°HK 2538	64	°BK 2538	68	34	66	10000		15	15	21	14	16	-	0.8	HK 1514 RS	12	HK 1516.2 RS	15	-	-	7.8	9.8	11000
28	28	35	16	-	0.8	HK 2816	29	-	-	16.4	26.5	9000		15	15	21	18	20	-	0.8	HK 1518 RS	16	HK 1520.2 RS	18	-	-	10.5	14.4	11000
	28	35	20	-	0.8	HK 2820	36	-	-	20.9	36	9000		16	16	22	14	16	11.3	0.8	HK 1614 RS	13	HK 1616.2 RS	14	BK 1614 RS	15	7.6	9.7	11000
30	30	37	12	9.3	0.8	HK 3012	23	BK 3012	28	12.1	18.2	8500		16	16	22	-	20	-	0.8	-	-	HK 1620.2 RS	18	-	-	10.9	15.3	11000
	30	37	16	13.3	0.8	HK 3016	31	BK 3016	38	17.2	29	8500		18	18	24	14	16	-	0.8	HK 1814 RS	14	HK 1816.2 RS	15	-	-	8.1	10.9	9500
	30	37	20	17.3	0.8	HK 3020	39	BK 3020	47	22	39.5	8500		20	20	26	-	16	-	0.8	-	-	HK 2016.2 RS	18	-	-	8.6	12.1	8500
	30	37	26	23.3	0.8	HK 3026	51	BK 3026	58	28	54	8500		20	20	26	18	20	15.3	0.8	HK 2018 RS	21	HK 2020.2 RS	23	BK 2018 RS	24	12.7	20.1	8500
	30	37	38	35.3	0.8	°HK 3038	76	°BK 3038	84	37.5	79	8500		22	22	28	14	16	-	0.8	HK 2214 RS	16	HK 2216.2 RS	18	-	-	9.1	13.4	8000
35	35	42	12	-	0.8	HK 3512	27	-	-	13.1	21.3	7500		22	22	28	18	20	-	0.8	HK 2218 RS	24	HK 2220.2 RS	26	-	-	13.4	22.1	8000
	35	42	16	-	0.8	HK 3516	36	-	-	18.7	33.5	7500		25	25	32	-	16	-	0.8	-	-	HK 2516.2 RS	27	-	-	11	15.2	7000
	35	42	20	17.3	0.8	HK 3520	44	BK 3520	53	23.8	46	7500		25	25	32	18	20	15.3	0.8	HK 2518 RS	29	HK 2520.2 RS	31	BK 2518 RS	34	15.6	24	7000
40	40	47	12	-	0.8	HK 4012	30	-	-	14	24.3	6500		25	25	32	-	24	-	0.8	-	-	HK 2524.2 RS	40	-	-	19.9	33	7000
	40	47	16	-	0.8	HK 4016	39	-	-	20	38.5	6500		25	25	32	-	30	-	0.8	-	-	HK 2530.2 RS	47	-	-	25.5	45	7000
	40	47	20	17.3	0.8	HK 4020	54	BK 4020	62	25.5	52	6500		28	28	35	18	20	-	0.8	HK 2818 RS	31	HK 2820.2 RS	34	-	-	16.4	26.5	6000
45	45	52	12	-	0.8	HK 4512	33	-	-	14.9	27.5	6500		30	30	37	-	16	-	0.8	-	-	HK 3016.2 RS	31	-	-	12.1	18.2	6000
	45	52	16	-	0.8	HK 4516	46	-	-	21.3	43	6500		30	30	37	18	20	-	0.8	HK 3018 RS	37	HK 3020.2 RS	36	-	-	17.2	29	6000
	45	52	20	17.3	0.8	HK 4520	56	BK 4520	72	27	59	6500		30	30	37	-	24	-	0.8	-	-	HK 3024.2 RS	44	-	-	22	39.5	6000
50	50	58	20	-	0.8	HK 5020	70	-	-	31	63	5000		35	35	42	-	16	-	0.8	-	-	HK 3516.2 RS	32	-	-	13.1	21.3	5000
	50	58	25	-	0.8	HK 5025	90	-	-	38.5	84	5000		35	35	42	18	20	-	0.8	HK 3518 RS	39	HK 3520.2 RS	41	-	-	18.7	33.5	5000
55	55	63	20	-	0.8	HK 5520	74	-	-	31.5	67	4700		40	40	47	-	16	-	0.8	-	-	HK 4016.2 RS	37	-	-	14	24.3	4500
	55	63	28	-	0.8	HK 5528	105	-	-	44	103	4700		40	40	47	18	20	-	0.8	HK 4018 RS	45	HK 4020.2 RS	48	-	-	20	38.5	4500
60	60	68	12	-	0.8	HK 6012	49	-	-	17.4	32	4400		45	45	52	18	20	-	0.8	HK 4518 RS	50	HK 4520.2 RS	54	-	-	21.3	43	4000
	60	68	20	-	0.8	HK 6020	81	-	-	33.5	75	4400		50	50	58	22	24	-	0.8	HK 5022 RS	76	HK 5024.2 RS	81	-	-	31	63	3600
	60	68	32	-	0.8	HK 6032	136	-	-	53	135	4400																	

TN is nylon cage, the running temperature is less than 120°C
 Part no. marked with symbol +, means such bearings are without lubrication holes.
 Part no. marked with symbol °, means such bearings are of standard double-row needle roller bearings, with lubrication holes.

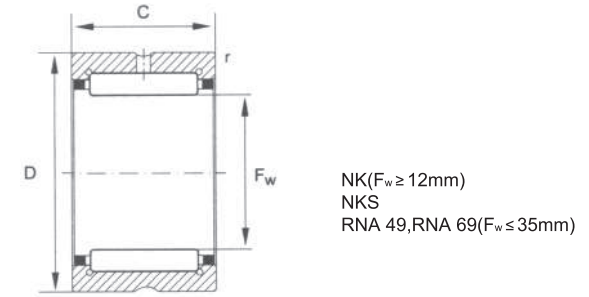
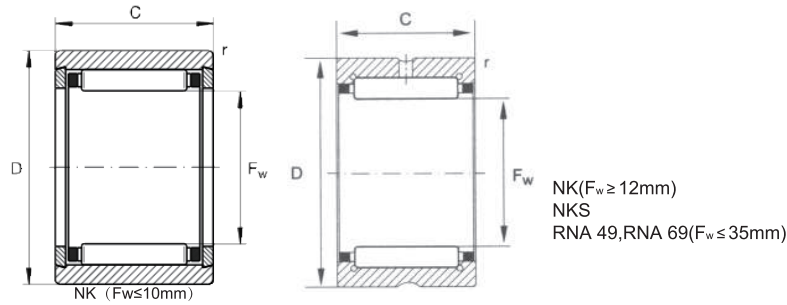

Shaft Diameter (mm)	Principal Dimensions (mm)				Bearing Designations			Basic Load Ratings (kN)			Limiting Speed (rpm) Oil Lubrication		Shaft Diameter (mm)	Principal Dimensions (mm)				Bearing Designations			Basic Load Ratings (kN)			Limiting Speed (rpm) Oil Lubrication		
	F _w	D	C	r _{min}	NK	RNA49	RNA69	Weight (g)	Dynamic Cr	Static Cor				F _w	D	C	r _{min}	NK	RNA49	RNA69	NKS	Weight (g)	Dynamic Cr		Static Cor	
5	5	10	10	0.15	+NK 5/10 TN	-	-	3.1	2.65	1.92	37000		20	20	28	16	0.3	NK 20/16	-	-	-	27	13	17.5	20000	
	5	10	12	0.15	+NK 5/12 TN	-	-	3.7	3	2.65	37000			20	28	20	0.3	NK 20/20	-	-	-	33.9	16.4	23.8	20000	
6	6	12	10	0.15	+NK 6/10 TN	-	-	4.7	2.6	2.28	33000		20	20	28	13	0.3	-	RNA 4902	-	-	21.7	10.6	13.6	22000	
	6	12	12	0.15	+NK 6/12 TN	-	-	5.7	3.35	3.15	33000			20	28	23	0.3	-	-	RNA 6902	-	-	39.7	17.3	25.5	20000
7	7	14	10	0.3	+NK 7/10 TN	-	-	6.9	2.85	2.65	31000		21	20	32	20	0.6	-	-	-	NKS 20	48.7	23	25	19000	
	7	14	12	0.3	+NK 7/12 TN	-	-	8.2	3.65	3.6	31000			21	29	16	0.3	NK 21/16	-	-	-	28.1	13.5	18.7	20000	
8	8	15	12	0.3	+NK 8/12 TN	-	-	8.7	3.95	4.1	29000		21	21	29	20	0.3	NK 21/20	-	-	-	35.2	17.1	25.5	20000	
	8	15	16	0.3	+NK 8/16 TN	-	-	12	5.1	5.8	29000			22	30	16	0.3	NK 22/16	-	-	-	30	14	19.9	19000	
9	9	16	12	0.3	+NK 9/12 TN	-	-	10.3	4.5	5	28000		22	22	30	20	0.3	NK 22/20	-	-	-	37	17.7	27	19000	
	9	16	16	0.3	+NK 9/16 TN	-	-	12.8	5.9	7.1	28000			22	30	13	0.3	-	RNA 4903	-	-	22.2	11	14.6	21000	
10	10	17	12	0.3	+NK 10/12 TN	-	-	10.1	4.75	5.5	27000		22	22	30	23	0.3	-	-	RNA 6903	-	-	42.4	18.6	29	19000
	10	17	16	0.3	+NK 10/16 TN	-	-	13.3	6.2	7.8	27000			22	35	20	0.6	-	-	-	NKS 22	61.5	24.5	28	17000	
12	12	19	12	0.3	NK 12/12	-	-	12.1	6.4	7.1	25000		24	24	32	16	0.3	NK 24/16	-	-	-	31.9	15	22.3	18000	
	12	19	16	0.3	NK 12/16	-	-	15.9	9	11	25000			24	32	20	0.3	NK 24/20	-	-	-	40	19	30.5	18000	
14	14	22	16	0.3	NK 14/16	-	-	20.7	10.1	11.5	24000		25	24	37	20	0.6	-	-	-	NKS 24	65.5	26	31	16000	
	14	22	20	0.3	NK 14/20	-	-	25.5	12.8	15.8	24000			25	33	16	0.3	NK 25/16	-	-	-	32.6	14.9	22.4	17000	
15	15	23	16	0.3	NK 15/16	-	-	21.8	10.7	12.7	23000		25	25	33	20	0.3	NK 25/20	-	-	-	42	18.8	30.5	17000	
	15	23	20	0.3	NK 15/20	-	-	26.6	13.5	17.4	23000			25	37	17	0.3	-	RNA 4904	-	-	52.3	21	25.5	17000	
16	16	24	16	0.3	NK 16/16	-	-	22.4	11.3	13.9	22000		26	25	37	30	0.3	-	-	RNA 6904	-	-	100	36	51	16000
	16	24	20	0.3	NK 16/20	-	-	28.4	14.4	18.8	22000			25	38	20	0.6	-	-	-	NKS 25	68.1	27.5	33.5	16000	
17	16	24	13	0.3	-	RNA 4901	-	17.4	9.4	10.9	24000		26	26	34	16	0.3	NK 26/16	-	-	-	34	15.3	23.6	16000	
	16	24	22	0.3	-	-	RNA 6901	31	16	21.6	22000			26	34	20	0.3	NK 26/20	-	-	-	42	19.4	32	16000	
18	17	25	16	0.3	NK 17/16	-	-	23.7	11.9	15	22000		28	28	37	20	0.3	NK 28/20	-	-	-	52.2	22	34	15000	
	17	25	20	0.3	NK 17/20	-	-	29.8	15.1	20.4	22000			28	37	30	0.3	NK 28/30	-	-	-	82	33	57	15000	
19	18	26	16	0.3	NK 18/16	-	-	24.9	12.5	16.2	21000		29	28	39	17	0.3	-	RNA 49/22	-	-	50.2	22.8	29.5	16000	
	18	26	20	0.3	NK 18/20	-	-	31.4	15.8	22	21000			28	39	30	0.3	-	-	RNA 69/22	-	-	98	37.5	55	15000
19	18	26	20	0.3	NK 18/20	-	-	31.4	15.8	22	21000		29	28	42	20	0.6	-	-	-	NKS 28	83.6	28.5	36.5	14000	
	19	27	16	0.3	NK 19/16	-	-	26.1	13	17.4	21000			29	38	20	0.3	NK 29/20	-	-	-	50	21.9	34	15000	
19	19	27	20	0.3	NK 19/20	-	-	32.2	16.5	23.6	21000		30	29	38	30	0.3	NK 29/30	-	-	-	84.3	32.5	57	15000	
	19	27	20	0.3	NK 19/20	-	-	32.2	16.5	23.6	21000			30	40	20	0.3	NK 30/20	-	-	-	61	22.6	36	14000	
19	19	27	20	0.3	NK 19/20	-	-	32.2	16.5	23.6	21000		30	30	40	30	0.3	NK 30/30	-	-	-	92.4	33.5	60	14000	
	19	27	20	0.3	NK 19/20	-	-	32.2	16.5	23.6	21000			30	42	17	0.3	-	RNA 4905	-	-	61	23.6	31.5	15000	
19	19	27	20	0.3	NK 19/20	-	-	32.2	16.5	23.6	21000		30	30	42	30	0.3	-	-	RNA 6905	-	-	112	39	59	14000
	19	27	20	0.3	NK 19/20	-	-	32.2	16.5	23.6	21000			30	45	22	0.6	-	-	-	NKS 30	104	32	40	13000	
19	19	27	20	0.3	NK 19/20	-	-	32.2	16.5	23.6	21000		32	32	42	20	0.3	NK 32/20	-	-	-	68	23.1	37.5	13000	
	19	27	20	0.3	NK 19/20	-	-	32.2	16.5	23.6	21000			32	42	30	0.3	NK 32/30	-	-	-	102	34.5	63	13000	
19	19	27	20	0.3	NK 19/20	-	-	32.2	16.5	23.6	21000		32	32	45	17	0.3	-	RNA 49/28	-	-	73.2	24.4	33.5	13000	
	19	27	20	0.3	NK 19/20	-	-	32.2	16.5	23.6	21000			32	45	30	0.3	-	-	RNA 69/28	-	-	73.5	40.5	63	13000
19	19	27	20	0.3	NK 19/20	-	-	32.2	16.5	23.6	21000		32	32	47	22	0.6	-	-	-	NKS 32	110	33.5	43.5	12000	

TN is nylon cage, the running temperature is less than 120°C
Part no. marked with symbol +, means such bearings are with snap ring, without lubrication groove and lubrication holes.

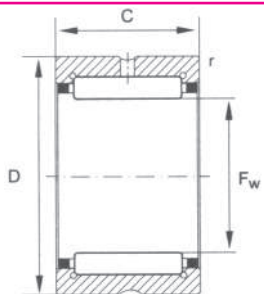

NK,NKS
RNA 49
RNA 69 (Fw ≤ 35mm)

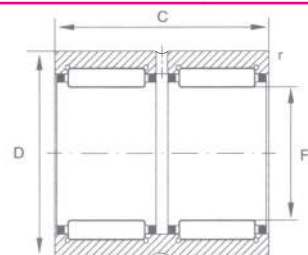

RNA69 (Fw ≥ 40mm)

Shaft Diameter (mm)	Principal Dimensions (mm)				Bearing Designations				Basic Load Ratings (KN)			Limiting Speed (rpm) Oil Lubrication			Shaft Diameter (mm)	Principal Dimensions (mm)				Bearing Designations				Basic Load Ratings (KN)			Limiting Speed (rpm) Oil Lubrication	
	Fw	D	C	r min	NK	RNA49	RNA69	NKS	Weight (g)	Dynamic Cr	Static Cor					Fw	D	C	r min	NK	RNA49	RNA69	NKS	Weight (g)	Dynamic Cr	Static Cor		
35	35	45	20	0.3	NK 35/20	-	-	-	69.4	24.3	41.5	12000			60	60	72	25	0.6	NK 60/25	-	-	-	170	42	90	7500	
	35	45	30	0.3	NK 35/30	-	-	-	106	36.5	69	12000				60	72	35	0.6	NK 60/35	-	-	-	258	56	130	7500	
	35	47	17	0.3	-	RNA 4906	-	-	69.4	25	35.5	13000				60	80	28	1.1	-	-	-	NKS 60	335	63	98	7000	
	35	47	30	0.3	-	-	RNA 6906	-	126	43.5	71	12000				63	63	80	25	1	-	RNA 4911	-	-	255	58	100	7500
	35	50	22	0.6	-	-	-	NKS 35	118	35	47	12000					63	80	45	1	-	-	RNA 6911	-	-	470	90	176
37	37	47	20	0.3	NK 37/20	-	-	-	77	24.9	43.5	12000			65	65	78	25	0.6	NK 65/25	-	-	-	221	44	98	7000	
	37	47	30	0.3	NK 37/30	-	-	-	113	37	73	12000				65	78	35	0.6	NK 65/35	-	-	-	310	59	142	7000	
	37	52	22	0.6	-	-	-	NKS 37	123	36.5	50	11000				65	85	28	1.1	-	-	-	NKS 65	356	67	108	6500	
38	38	48	20	0.3	NK 38/20	-	-	-	79.4	25.5	45	11000			68	68	82	25	0.6	NK 68/25	-	-	-	241	43.5	89	6500	
	38	48	30	0.3	NK 38/30	-	-	-	116	38	76	11000				68	82	35	0.6	NK 68/35	-	-	-	338	62	139	6500	
40	40	50	20	0.3	NK 40/20	-	-	-	78	26	47	11000				68	85	25	1	-	RNA 4912	-	-	275	60	108	7000	
	40	50	30	0.3	NK 40/30	-	-	-	125	39	79	11000				68	85	45	1	-	-	RNA 6912	-	-	488	94	191	6500
	40	52	20	0.6	-	RNA 49/32	-	-	89.1	30.5	47.5	12000			70	70	85	25	0.6	NK 70/25	-	-	-	260	44.5	92	6500	
	40	52	36	0.6	-	-	RNA 69/32	-	162	47	82	11000				70	85	35	0.6	NK 70/35	-	-	-	370	63	144	6500	
	40	55	22	0.6	-	-	-	NKS 40	129	38	54	10000				70	90	28	1.1	-	-	-	NKS 70	380	68	113	6000	
42	42	52	20	0.3	NK 42/20	-	-	-	85.8	36.5	49	10000			72	72	90	25	1	-	RNA 4913	-	-	312	61	112	6500	
	42	52	30	0.3	NK 42/30	-	-	-	130	39.5	82	10000				72	90	45	1	-	-	RNA 6913	-	-	580	95	198	6000
	42	55	20	0.6	-	RNA 4907	-	-	107	31.5	50	11000			73	73	90	25	1	NK 73/25	-	-	-	302	53	100	6000	
	42	55	36	0.6	-	-	RNA 6907	-	193	48	86	10000				73	90	35	1	NK 73/35	-	-	-	428	75	156	6000	
43	43	53	20	0.3	NK 43/20	-	-	-	86	27	51	10000			75	75	92	25	1	NK 75/25	-	-	-	315	54	104	6000	
	43	53	30	0.3	NK 43/30	-	-	-	133	40.5	85	10000				75	92	35	1	NK 75/35	-	-	-	445	77	162	6000	
	43	58	22	0.6	-	-	-	NKS 43	139	39	57	9500				75	95	28	1.1	-	-	-	NKS 75	402	71	123	6000	
45	45	55	20	0.3	NK 45/20	-	-	-	85.3	27.5	53	10000			80	80	95	25	1	NK 80/25	-	-	-	301	56	119	5500	
	45	55	30	0.3	NK 45/30	-	-	-	132	41	88	10000				80	95	35	1	NK 80/35	-	-	-	425	78	184	5500	
	45	60	22	0.6	-	-	-	NKS 45	145	40.5	60	9500				80	100	30	1	-	RNA 4914	-	-	460	84	156	6000	
45	60	30	0.6	-	-	-	-	145	40.5	60	9500			80		100	54	1	-	-	RNA 6914	-	-	857	128	265	5500	
47	47	57	20	0.3	NK 47/20	-	-	-	94.5	28.5	56	9500			85	85	105	25	1	NK 85/25	-	-	-	425	69	123	5000	
	47	57	30	0.3	NK 47/30	-	-	-	142	43	94	9500				85	105	35	1	NK 85/35	-	-	-	600	98	193	5000	
48	48	62	22	0.6	-	RNA 4908	-	-	140	43	67	9500				85	105	30	1	-	RNA 4915	-	-	489	86	162	5500	
	48	62	40	0.6	-	-	RNA 6908	-	256	66	116	9000				85	105	54	1	-	-	RNA 6915	-	-	935	130	275	5000
	48	62	25	0.6	NK 50/25	-	-	-	146	38	74	9000				90	90	110	25	1	NK 90/25	-	-	-	450	72	132	4900
50	50	62	35	0.6	NK 50/35	-	-	-	207	50	106	9000			90		110	35	1	NK 90/35	-	-	-	630	103	208	4900	
	50	65	22	1	-	-	-	NKS 50	157	42.5	67	8500			90		110	30	1	-	RNA 4916	-	-	516	89	174	5000	
52	52	68	22	0.6	-	RNA 4909	-	-	182	45	73	8500			95	95	115	26	1	NK 95/26	-	-	-	490	73	137	4700	
	52	68	40	0.6	-	-	RNA 6909	-	338	69	127	8000				95	115	36	1	NK 95/36	-	-	-	680	107	223	4700	
55	55	68	25	0.6	NK 55/25	-	-	-	180	40	82	8000			58	58	72	22	0.6	-	RNA 4910	-	-	163	47	80	8000	
	55	68	35	0.6	NK 55/35	-	-	-	250	53	118	8000				58	72	40	0.6	-	-	RNA 6910	-	-	310	73	139	7500
	55	72	22	1	-	-	-	NKS 55	221	45	74	7500																

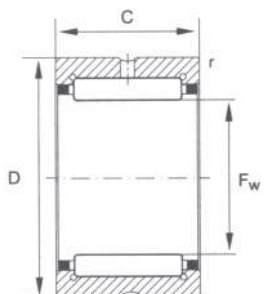

NK
RNA 49, RNA 48

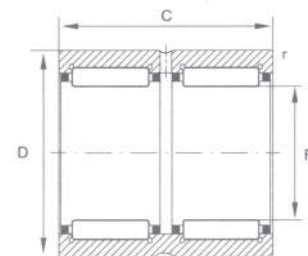

RNA69 (Fw≥40mm)

Shaft Diameter (mm)	Principal Dimensions (mm)				Bearing Designations			Basic Load Ratings (kN)		Limiting Speed (rpm) Oil Lubrication		Shaft Diameter (mm)	Principal Dimensions (mm)				Bearing Designations			Basic Load Ratings (kN)		Limiting Speed (rpm) Oil Lubrication
	Fw	D	C	r min	NK	RNA49	RNA69	Weight (g)	Dynamic Cr				Static Cor	Fw	D	C	r min	RNA49	RNA48	Weight (g)	Dynamic Cr	
100	100	120	26	1	NK 100/26	-	-	515	76	146	4500	115	115	140	40	1.1	RNA 4920	-	1150	128	270	4100
	100	120	36	1	NK 100/36	-	-	715	111	237	4500	120	120	140	30	1	-	RNA 4822	670	94	216	3800
	100	120	35	1.1	-	RNA 4917	-	657	111	237	4800	125	125	150	40	1.1	RNA 4922	-	1240	132	290	3800
	100	120	63	1.1	-	-	RNA 6917	1200	166	400	4500	130	130	150	30	1	-	RNA 4824	730	99	239	3500
105	105	125	26	1	NK 105/26	-	-	540	78	155	4300	135	135	165	45	1.1	RNA 4924	-	1860	181	390	3400
	105	125	36	1	NK 105/36	-	-	713	114	250	4300	145	145	165	35	1.1	-	RNA 4826	990	118	310	3200
	105	125	35	1.1	-	RNA 4918	-	745	114	250	4600	150	150	180	50	1.5	RNA 4926	-	2210	203	470	3200
	105	125	63	1.1	-	-	RNA 6918	1330	172	425	4300	155	155	175	35	1.1	-	RNA 4828	1050	120	325	3000
110	110	130	30	1.1	NK 110/30	-	-	650	98	210	4100	160	160	190	50	1.5	RNA 4928	-	2350	209	500	3000
	110	130	40	1.1	NK 110/40	-	-	830	127	290	4100	165	165	190	40	1.1	-	RNA 4830	1600	152	400	2800
	110	130	35	1.1	-	RNA 4919	-	719	116	260	4400	175	175	200	40	1.1	-	RNA 4832	1700	160	435	2600
	110	130	63	1.1	-	-	RNA 6919	1460	174	440	4100	185	185	215	45	1.1	-	RNA 4834	2540	185	510	2500
												195	195	225	45	1.1	-	RNA 4836	2680	194	550	2300
												210	210	240	50	1.5	-	RNA 4838	3210	227	690	2200
												220	220	250	50	1.5	-	RNA 4840	3350	230	720	2100
												240	240	270	50	1.5	-	RNA 4844	3620	243	790	1900
												265	265	300	60	2	-	RNA 4848	5400	355	1080	1700
												285	285	320	60	2	-	RNA 4852	5800	370	1160	1600
												305	305	350	69	2	-	RNA 4856	9300	450	1300	1500
												330	330	380	80	2.1	-	RNA 4860	12700	620	1770	1400
												350	350	400	80	2.1	-	RNA 4864	13400	630	1850	1300
												370	370	420	80	2.1	-	RNA 4868	14000	640	1940	1200
												390	390	440	80	2.1	-	RNA 4872	14800	660	2020	1200
												415	415	480	100	2.1	-	RNA 4876	26000	1000	2900	1100

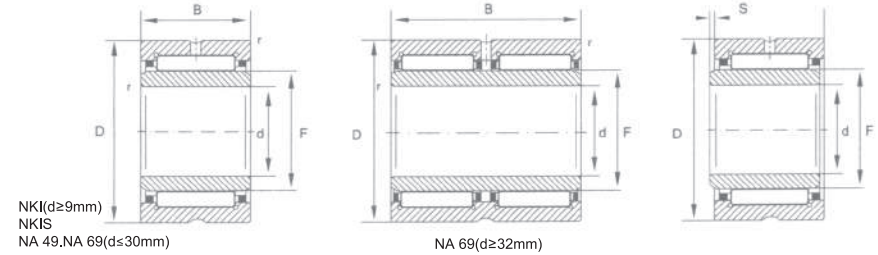
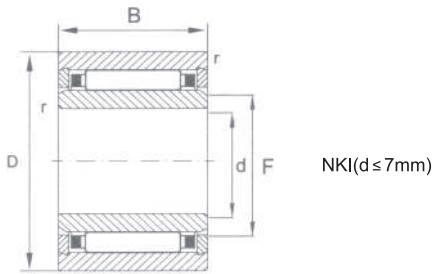

Shaft Diameter (mm)	Principal Dimensions (mm)					Bearing Designations				Basic Load Ratings (kN)			Limiting Speed (rpm) Oil Lubrication
	d	F	D	B	r _{min} S ¹⁾	NKI	RNA 49	NA 69	NKIS	Weight (g)	Dynamic Cr	Static Cor	
5	5	8	15	12	0.3 1.5	+NKI 5/12 TN	-	-	-	11.5	3.95	4.1	32000
	5	8	15	16	0.3 2	+NKI 5/16 TN	-	-	-	15.3	5.1	5.8	32000
6	6	9	16	12	0.3 1.5	+NKI 6/12 TN	-	-	-	13.5	4.5	5	30000
	6	9	16	16	0.3 2	+NKI 6/16 TN	-	-	-	17.4	5.9	7.1	30000
7	7	10	17	12	0.3 1.5	+NKI 7/12 TN	-	-	-	13.7	4.75	5.5	29000
	7	10	17	16	0.3 2	+NKI 7/16 TN	-	-	-	18.2	6.2	7.8	29000
9	9	12	19	12	0.3 1.5	NKI 9/12	-	-	-	16.6	6.4	7.1	27000
	9	12	19	16	0.3 2	NKI 9/16	-	-	-	21.9	9	11	27000
10	10	14	22	16	0.3 0.5	NKI 10/16	-	-	-	29.4	10.1	11.5	25000
	10	14	22	20	0.3 0.5	NKI 10/20	-	-	-	37.1	12.8	15.6	25000
	10	14	22	13	0.3 0.5	-	NA 4900	-	-	23	8.5	9.2	25000
12	12	16	24	16	0.3 0.5	NKI 12/16	-	-	-	33.3	11.3	13.9	24000
	12	16	24	20	0.3 0.5	NKI 12/20	-	-	-	41.9	14.4	18.8	24000
	12	16	24	13	0.3 0.5	-	NA 4901	-	-	26	9.4	10.9	24000
	12	16	24	22	0.3 1	-	-	NA 6901	-	46	16	21.6	24000
15	15	19	27	16	0.3 0.5	NKI 15/16	-	-	-	38.8	13	17.4	22000
	15	19	27	20	0.3 0.5	NKI 15/20	-	-	-	48.7	16.5	23.6	22000
	15	20	28	13	0.3 0.5	-	NA 4902	-	-	34	10.6	13.6	22000
	15	20	28	23	0.3 1	-	-	NA 6902	-	63.6	17.3	25.5	22000
	15	22	35	20	0.6 0.5	-	-	-	NKIS 15	92	24.5	28	20000
17	17	21	29	16	0.3 0.5	NKI 17/16	-	-	-	42.4	13.5	18.7	21000
	17	21	29	20	0.3 0.5	NKI 17/20	-	-	-	53.4	17.1	25.5	21000
	17	22	30	13	0.3 0.5	-	NA 4903	-	-	37	11	14.6	21000
	17	22	30	23	0.3 1	-	-	NA 6903	-	72	18.6	29	21000
	17	24	37	20	0.6 0.5	-	-	-	NKIS 17	98	26	31	18000

TN is nylon cage, the running temperature is less than 120°C
 Part no. marked with symbol +, means such bearings are with snap ring, without lubrication groove and lubrication holes.
¹⁾ Axial displacement of inner ring allowed

Shaft Diameter (mm)	Principal Dimensions (mm)					Bearing Designations				Basic Load Ratings (kN)			Limiting Speed (rpm) Oil Lubrication
	d	F	D	B	r _{min} S ¹⁾	NKI	NA 49	NA 69	NKIS	Weight (g)	Dynamic Cr	Static Cor	
20	20	24	32	16	0.3 0.5	NKI 20/16	-	-	-	49	15	22.3	19000
	20	24	32	20	0.3 0.5	NKI 20/20	-	-	-	61	19	30.5	19000
	20	25	37	17	0.3 0.8	-	NA 4904	-	-	75.2	21	25.5	17000
	20	25	37	30	0.3 1	-	-	NA 6904	-	141	36	51	17000
22	20	28	42	20	0.6 0.5	-	-	-	NKIS 20	129	28.5	36.5	16000
	22	26	34	16	0.3 0.5	NKI 22/16	-	-	-	52	15.3	23.6	18000
	22	26	34	20	0.3 0.5	NKI 22/20	-	-	-	65.4	19.4	32	18000
	22	28	39	17	0.3 0.8	-	NA 49/22	-	-	80	22.8	29.5	16000
25	22	28	39	30	0.3 0.5	-	-	NA 69/22	-	150	37.5	55	16000
	25	29	38	20	0.3 1	NKI 25/20	-	-	-	75.8	21.9	34	16000
	25	29	38	30	0.3 1.5	NKI 25/30	-	-	-	124	32.5	57	16000
	25	30	42	17	0.3 0.8	-	NA 4905	-	-	88	23.6	31.5	15000
28	25	30	42	30	0.3 1	-	-	NA 6905	-	161	39	59	15000
	25	32	47	22	0.6 1	-	-	-	NKIS 25	162	33.5	43.5	14000
	28	32	42	20	0.3 1	NKI 28/20	-	-	-	92.4	23.1	37.5	14000
	28	32	42	30	0.3 1.5	NKI 28/30	-	-	-	146	34.5	63	14000
30	28	32	45	17	0.3 0.8	-	NA 49/28	-	-	97.7	24.4	33.5	13000
	28	32	45	30	0.3 1	-	-	NA 69/28	-	182	40.5	63	13000
	30	35	45	20	0.3 0.5	NKI 30/20	-	-	-	108	24.3	41.5	13000
	30	35	45	30	0.3 1	NKI 30/30	-	-	-	165	36	69	13000
32	30	35	47	17	0.3 0.8	-	NA 4906	-	-	101	25	35.5	13000
	30	35	47	30	0.3 1	-	-	NA 6906	-	192	43.5	71	13000
	30	37	52	22	0.6 1	-	-	-	NKIS 30	184	36.5	50	12000
	32	37	47	20	0.3 0.5	NKI 32/20	-	-	-	118	24.9	43.5	12000
35	32	37	47	30	0.3 1	NKI 32/30	-	-	-	180	37	73	12000
	32	40	52	20	0.6 0.8	-	NA 49/32	-	-	158	30.5	47.5	12000
	32	40	52	36	0.6 0.5	-	-	NA 69/32	-	288	47	82	12000
	35	40	50	20	0.3 0.5	NKI 35/20	-	-	-	122	26	47	12000
35	35	40	50	30	0.3 1	NKI 35/30	-	-	-	193	39	79	12000
	35	42	55	20	0.6 0.8	-	NA 4907	-	-	170	31.5	50	11000
	35	42	55	36	0.6 0.5	-	-	NA 6907	-	310	48	86	11000
	35	43	58	22	0.6 0.5	-	-	-	NKIS 35	220	39	57	11000

¹⁾ Axial displacement of inner ring allowed

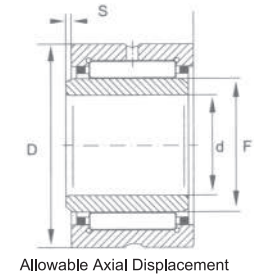
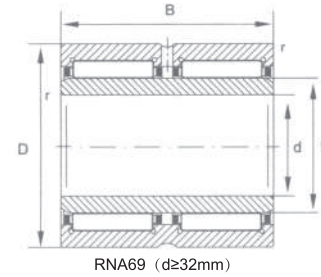
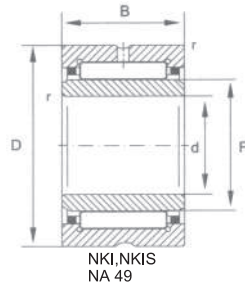

Shaft Diameter (mm)	Principal Dimensions (mm)						Bearing Designations				Basic Load Ratings (kN)			Limiting Speed (rpm) Oil Lubrication		Shaft Diameter (mm)	Principal Dimensions (mm)						Bearing Designations				Basic Load Ratings (kN)			Limiting Speed (rpm) Oil Lubrication
	d	F	D	B	r _{min}	S ¹⁾	NKI	NA 49	NA 69	NKIS	Weight (g)	Dynamic Cr	Static Cor				d	F	D	B	r _{min}	S ¹⁾	NKI	NA 49	NA 69	Weight (g)	Dynamic Cr	Static Cor		
38	38	43	53	20	0.3	0.5	NKI 38/20	-	-	-	136	27	51	11000		70	70	80	95	25	1.0	0.8	NKI 70/25	-	-	521	56	119	6000	
	38	43	53	30	0.3	1.0	NKI 38/30	-	-	-	207	45	85	11000			70	80	95	35	1.0	0.8	NKI 70/35	-	-	737	78	184	6000	
40	40	45	55	20	0.3	0.5	NKI 40/20	-	-	-	136	27.5	53	10000		70	70	80	100	30	1.0	1.5	-	NA 4914	-	728	84	156	6000	
	40	45	55	30	0.3	1.0	NKI 40/30	-	-	-	216	41	88	10000			70	80	100	54	1.0	1.0	-	-	NA 6914	1340	128	265	6000	
	40	48	62	22	0.6	1.0	-	NA 4908	-	-	230	43	67	9500			75	85	105	25	1.0	1.0	NKI 75/25	-	-	641	69	123	5500	
	40	48	62	40	0.6	0.5	-	-	NA 6908	-	430	66	116	9500			75	85	105	35	1.0	1.0	NKI 75/35	-	-	908	98	193	5500	
42	40	50	65	22	1.0	0.5	-	-	-	NKIS 40	281	42.5	67	9500		75	85	105	30	1.0	1.5	-	NA 4915	-	775	86	162	5500		
	42	47	57	20	0.3	0.5	NKI 42/20	-	-	-	148	28.5	56	10000		75	85	105	54	1.0	1.0	-	-	NA 6915	1450	130	275	5500		
	42	47	57	30	0.3	1.0	NKI 42/30	-	-	-	222	43	94	10000		80	80	90	110	25	1.0	1.0	NKI 80/25	-	-	677	72	132	5000	
	45	50	62	25	0.6	1.5	NKI 45/25	-	-	-	217	38	74	9000			80	90	110	35	1.0	1.0	NKI 80/35	-	-	959	103	208	5000	
45	50	62	35	0.6	2.0	NKI 45/35	-	-	-	308	50	106	9000		80		90	110	30	1.0	1.5	-	NA 4916	-	878	89	174	5000		
45	52	68	22	0.6	1.0	-	NA 4909	-	-	271	45	73	8500		80		90	110	54	1.0	1.0	-	-	NA 6916	1522	135	300	5000		
45	45	52	68	40	0.6	0.5	-	-	NA 6909	-	495	69	127	8500		85	85	95	115	26	1.0	1.5	NKI 85/26	-	-	743	73	137	4900	
	45	52	68	40	0.6	0.5	-	-	NA 6909	-	495	69	127	8500			85	95	115	36	1.0	1.5	NKI 85/36	-	-	1040	107	223	4900	
	45	55	72	22	1.0	0.5	-	-	-	NKIS 45	336	45	74	8500			85	100	120	35	1.1	1.0	-	NA 4917	-	1250	111	237	4900	
	50	55	68	25	0.6	1.5	NKI 50/25	-	-	-	270	40	82	8500			85	100	120	63	1.1	1.0	-	-	NA 6917	2200	166	400	4900	
50	50	55	68	35	0.6	2.0	NKI 50/35	-	-	-	379	53	118	8500		90	95	100	120	26	1.0	1.5	NKI 90/26	-	-	778	76	146	4700	
	50	58	72	22	0.6	1.0	-	NA 4910	-	274	47	80	8000		95		100	120	36	1.0	1.5	NKI 90/36	-	-	1090	111	237	4700		
	50	58	72	40	0.6	0.5	-	-	NA 6910	-	515	73	139	8000			95	105	125	35	1.1	1.0	-	NA 4918	-	1312	114	250	4600	
	50	60	80	28	1.1	2.0	-	-	-	NKIS 50	518	63	98	7500			95	105	125	63	1.1	1.0	-	-	NA 6918	2310	172	425	4600	
55	55	60	72	25	0.6	1.5	NKI 55/25	-	-	-	255	42	90	7500		95	95	105	125	26	1.0	1.5	NKI 95/26	-	-	816	78	155	4500	
	55	60	72	35	0.6	2.0	NKI 55/35	-	-	-	379	56	130	7500			95	105	125	36	1.0	1.5	NKI 95/36	-	-	1145	114	250	4500	
	55	63	80	25	1.0	1.5	-	NA 4911	-	393	58	100	7500		95		110	130	35	1.1	1.0	-	NA 4919	-	1371	116	260	4400		
	55	63	80	45	1.0	1.5	-	-	NA 6911	-	780	90	176	7500			95	110	130	63	1.1	1.0	-	-	NA 6919	2500	174	440	4400	
60	55	65	85	28	1.1	2.0	-	-	-	NKIS 55	558	67	108	7000		95	95	110	130	35	1.1	1.0	-	-	-	1371	116	260	4400	
	60	68	82	25	0.6	1.0	NKI 60/25	-	-	-	394	43.5	89	7000			95	110	130	63	1.1	1.0	-	-	-	2500	174	440	4400	
	60	68	82	35	0.6	1.0	NKI 60/35	-	-	-	553	62	139	7000			95	110	130	63	1.1	1.0	-	-	-	2500	174	440	4400	
	60	68	85	25	1.0	1.5	-	NA 4912	-	426	60	108	7000		95		110	130	63	1.1	1.0	-	-	-	2500	174	440	4400		
65	60	68	85	45	1.0	1.5	-	-	NA 6912	-	808	94	191	7000		95	95	105	125	63	1.1	1.0	-	-	-	2500	174	440	4400	
	60	70	90	28	1.1	2.0	-	-	-	NKIS 60	560	68	113	6500			95	105	125	26	1.0	1.5	NKI 95/26	-	-	816	78	155	4500	
	65	73	90	25	1.0	1.0	NKI 65/25	-	-	-	467	53	100	6500			95	105	125	36	1.0	1.5	NKI 95/36	-	-	1145	114	250	4500	
	65	73	90	35	1.0	1.0	NKI 65/35	-	-	-	659	75	156	6500			95	110	130	35	1.1	1.0	-	NA 4919	-	1371	116	260	4400	
	65	72	90	25	1.0	1.5	-	NA 4913	-	456	61	112	6500		95		110	130	63	1.1	1.0	-	-	NA 6919	2500	174	440	4400		
	65	72	90	45	1.0	1.5	-	-	NA 6913	-	833	95	198	6500			95	110	130	63	1.1	1.0	-	-	-	2500	174	440	4400	
65	75	95	28	1.1	2.0	-	-	-	NKIS 65	641	71	123	6500		95	110	130	63	1.1	1.0	-	-	-	2500	174	440	4400			

Allowable axial displacement of inner ring relative to outer ring

Allowable axial displacement of inner ring relative to outer ring

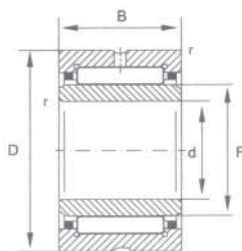

NKI
NA 49,NA 48

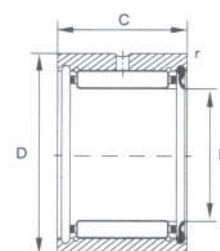

RNA 49..RS

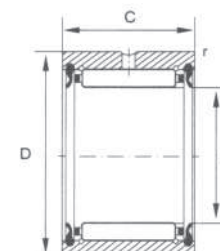

RNA 49..2RS

Shaft Diameter (mm)	Principal Dimensions (mm)						Bearing Designations			Basic Load Ratings (KN)		Limiting Speed (rpm) Oil Lubrication		Shaft Diameter (mm)	Principal Dimensions (mm)					Bearing Designations		Basic Load Ratings (KN)		Limiting Speed (rpm) Oil Lubrication
	d	F	D	B	r _{min}	S ¹⁾	NKI	NA 49	NA 48	Weight (g)	Dynamic Cr				Static Cor	Fw	D	C	r _{min}	RNA 49..RS Single Seal	RNA 49..RS Double Seals	Weight (g)	Dynamic Cr	
100	100	110	130	30	1.1	1.5	NKI 100/30	-	-	990	98	210	4300	14	14	22	13	0.3	RNA 4900 RS	RNA 4900 2RS	16	6.8	6.9	13000
	100	110	130	40	1.1	2.0	NKI 100/40	-	-	1330	127	290	4300	16	16	24	13	0.3	RNA 4901 RS	RNA 4901 2RS	18	7.6	8.3	12000
	100	115	140	40	1.1	2.0	-	NA 4920	-	1900	128	270	4100	20	20	28	13	0.3	RNA 4902 RS	RNA 4902 2RS	21.5	8.6	10.6	10000
110	110	125	150	40	1.1	2.0	-	NA 4922	-	2070	132	290	3800	22	22	30	13	0.3	RNA 4903 RS	RNA 4903 2RS	23	8.8	11	9000
	110	120	140	30	1.0	0.8	-	-	NA 4822	1080	94	216	3900	25	25	37	17	0.3	RNA 4904 RS	RNA 4904 2RS	56	17.3	19.9	7500
120	120	135	165	45	1.1	2.0	-	NA 4924	-	2860	181	390	3400	30	30	42	17	0.3	RNA 4905 RS	RNA 4905 2RS	60	19.3	24.2	6500
	120	130	150	30	1.0	0.8	-	-	NA 4824	1170	99	239	3600	35	35	47	17	0.3	RNA 4906 RS	RNA 4906 2RS	69	21.1	28.5	5500
130	130	150	180	50	1.5	1.5	-	NA 4926	-	3900	203	470	3200	42	42	55	20	0.6	RNA 4907 RS	RNA 4907 2RS	107	26.5	39.5	4800
	130	145	165	35	1.1	1.0	-	-	NA 4826	1810	118	310	3300	48	48	62	22	0.6	RNA 4908 RS	RNA 4908 2RS	154	36	53	4200
140	140	160	190	50	1.5	1.5	-	NA 4928	-	4150	209	500	3000	52	52	68	22	0.6	RNA 4909 RS	RNA 4909 2RS	157	38	59	3900
	140	155	175	35	1.1	1.0	-	-	NA 4828	1920	120	325	3100	58	58	72	22	0.6	RNA 4910 RS	RNA 4910 2RS	160	40	64	3500
150	150	165	190	40	1.1	1.5	-	-	NA 4830	2720	152	400	2900											
160	160	175	200	40	1.1	1.5	-	-	NA 4832	2890	160	435	2700											
170	170	185	215	45	1.1	1.5	-	-	NA 4834	3960	185	510	2500											
180	180	195	225	45	1.1	1.5	-	-	NA 4836	4200	194	550	2400											
190	190	210	240	50	1.5	1.5	-	-	NA 4838	5610	227	690	2300											

Allowable axial displacement of inner ring relative to outer ring

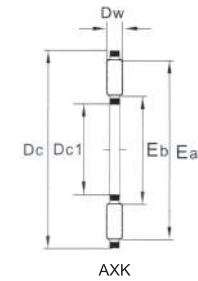
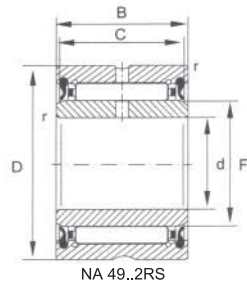
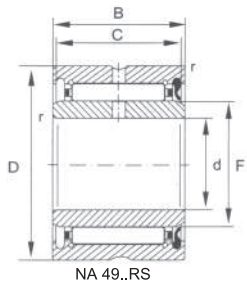

Shaft Diameter (mm)	Principal Dimensions (mm)							Bearing Designations			Basic Load Ratings (kN)		Limiting Speed (rpm) Oil Lubrication	Shaft Diameter (mm)	Needle Roller Thrust Bearing and Cage Parts		Bearing Designations					
	d	F	D	C	B	r	min	NA 49..RS Single Seal	NA 49..RS Double Seals	Weight (g)	Dynamic Cr	Static Cor			Bearing Designation	Weight (g)	Thrust Washer	Weight (g)	Raceway Washer	Shaft Washer	Housing Washer	Weight (g)
10	10	14	22	13	14	0.3		NA 4900 RS	NA 4900 2RS	24.5	6.8	6.9	13000	4	AXK 0414 TN	0.7	AS 0414	1	-	-	-	-
12	12	16	24	13	14	0.3		NA 4901 RS	NA 4901 2RS	27.5	7.6	8.3	12000	5	AXK 0515 TN	0.8	AS 0515	1	-	-	-	-
15	15	20	28	13	14	0.3		NA 4902 RS	NA 4902 2RS	37	8.6	10.6	10000	6	AXK 0619 TN	1	AS 0619	2	LS 0619	-	-	4
17	17	22	30	13	14	0.3		NA 4903 RS	NA 4903 2RS	40	8.8	11	9000	8	AXK 0821 TN	2	AS 0821	2	LS 0821	-	-	4
20	20	25	37	17	18	0.3		NA 4904 RS	NA 4904 2RS	80	17.3	19.9	7500	10	AXK 1024	3	AS 1024	3	LS 1024	-	-	7
25	25	30	42	17	18	0.3		NA 4905 RS	NA 4905 2RS	89.5	19.3	24.2	6500	12	AXK 1226	3	AS 1226	3	LS 1226	-	-	8
30	30	35	47	17	18	0.3		NA 4906 RS	NA 4906 2RS	104	21.1	28.5	5500	15	AXK 1528	4	AS 1528	3	LS 1528	GS 81102	WS 81102	9
35	35	42	55	20	21	0.6		NA 4907 RS	NA 4907 2RS	175	26.5	39.5	4800	17	AXK 1730	4	AS 1730	4	LS 1730	GS 81103	WS 81103	9
40	40	48	62	22	23	0.6		NA 4908 RS	NA 4908 2RS	252	36	53	4200	20	AXK 2035	5	AS 2035	5	LS 2035	GS 81104	WS 81104	13
45	45	52	68	22	23	0.6		NA 4909 RS	NA 4909 2RS	290	38	59	3900	25	AXK 2542	7	AS 2542	7	LS 2542	GS 81105	WS 81105	19
50	50	58	72	22	23	0.6		NA 4910 RS	NA 4910 2RS	295	40	64	3500	30	AXK 3047	8	AS 3047	8	LS 3047	GS 81106	WS 81106	22
														35	AXK 3552	10	AS 3552	9	LS 3552	GS 81107	WS 81107	29
														40	AXK 4060	16	AS 4060	12	LS 4060	GS 81108	WS 81108	40
														45	AXK 4565	18	AS 4565	13	LS 4565	GS 81109	WS 81109	50
														50	AXK 5070	20	AS 5070	14	LS 5070	GS 81110	WS 81110	55
														55	AXK 5578	28	AS 5578	18	LS 5578	GS 81111	WS 81111	88
														60	AXK 6085	33	AS 6085	22	LS 6085	GS 81112	WS 81112	97
														65	AXK 6590	35	AS 6590	24	LS 6590	GS 81113	WS 81113	115
														70	AXK 7095	60	AS 7095	25	LS 7095	GS 81114	WS 81114	123
														75	AXK 75100	61	AS 75100	27	LS 75100	GS 81115	WS 81115	142
														80	AXK 80105	63	AS 80105	28	LS 80105	GS 81116	WS 81116	151
														85	AXK 85110	67	AS 85110	29	LS 85110	GS 81117	WS 81117	159
														90	AXK 90120	86	AS 90120	39	LS 90120	GS 81118	WS 81118	234
														100	AXK 100135	104	AS 100135	50	LS 100135	GS 81120	WS 81120	350
														110	AXK 110145	122	AS 110145	55	LS 110145	GS 81122	WS 81122	385
														120	AXK 120155	131	AS 120155	59	LS 120155	GS 81124	WS 81124	415
														130	AXK 130170	205	AS 130170	65	LS 130170	GS 81126	WS 81126	663
														140	AXK 140180	219	AS 140180	79	LS 140180	GS 81128	WS 81128	749
														150	AXK 150190	323	AS 150190	84	LS 150190	GS 81130	WS 81130	796
														160	AXK 160200	246	AS 160200	89	LS 160200	GS 81132	WS 81132	842

) limiting speed of grease lubrication.

TN is nylon cage, the running temperature is less than 120°C

) limiting speed of grease lubrication.

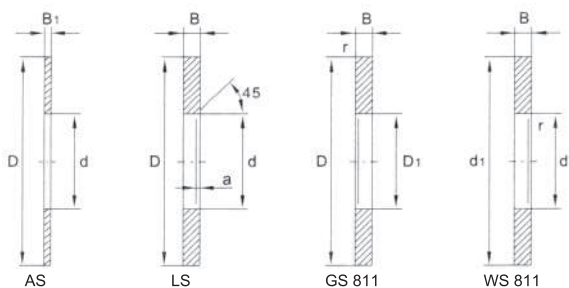

Principal Dimensions (mm)								Bearing Designations		Basic Load Ratings (KN)		Limiting Speed (rpm)
Dc1 d	D1	Dc D	d1	Dw	B1	B	a r min	Eb	Ea	Dynamic Cr	Static Cor	
4	-	14	-	2	1	-	-	5	13	4.4	8	21000
5	-	15	-	2	1	-	-	6	14	4.75	9.2	21000
6	-	19	-	2	1	2.75	0.3	7	18	6.8	15.5	19000
8	-	21	-	2	1	2.75	0.3	9	20	7.8	19.4	18000
10	-	24	-	2	1	2.75	0.3	12	23	9.2	25.5	17000
12	-	26	-	2	1	2.75	0.3	14	25	9.9	29	15000
15	16	28	28	2	1	2.75	0.3	17	27	11.3	36	13000
17	18	30	30	2	1	2.75	0.3	19	29	11.9	39.5	12000
20	21	35	35	2	1	2.75	0.3	22	34	13.1	46.5	10000
25	26	42	42	2	1	3	0.6	29	41	14.7	58	8500
30	32	47	47	2	1	3	0.6	34	46	16.3	70	7500
35	37	52	52	2	1	3.5	0.6	39	51	17.8	81	6500
40	42	60	60	3	1	3.5	0.6	45	58	28	114	6000
45	47	65	65	3	1	4	0.6	50	63	30	128	5000
50	52	70	70	3	1	4	0.6	55	68	32	143	4800
55	57	78	78	3	1	5	0.6	60	76	38	186	4300
60	62	85	85	3	1	4.75	1	65	83	44.5	234	4000
65	67	90	90	3	1	5.25	1	70	88	46.5	255	3700
70	72	95	95	4	1	5.25	1	74	93	54	255	3500
75	77	100	100	4	1	5.75	1	79	98	55	265	3300
80	82	105	105	4	1	5.75	1	84	103	56	280	3100
85	87	110	110	4	1	5.75	1	89	108	58	290	3000
90	92	120	120	4	1	6.5	1	94	118	73	405	2700
100	102	135	135	4	1	7	1	105	133	91	560	2500
110	112	145	145	4	1	7	1	115	143	97	620	2300
120	122	155	155	4	1	7	1	125	153	102	680	2100
130	132	170	170	5	1	9	1	136	167	133	840	1900
140	142	180	178	5	1	9.5	1	146	177	138	900	1800
150	152	190	188	5	1	9.5	1	156	187	143	960	1700
160	162	200	198	5	1	9.5	1	166	197	148	1020	1600